

BLOCK A



Carpet Area = 153.26 sq.mt

Super area = 189.90 sq.mt.

BLOCK A

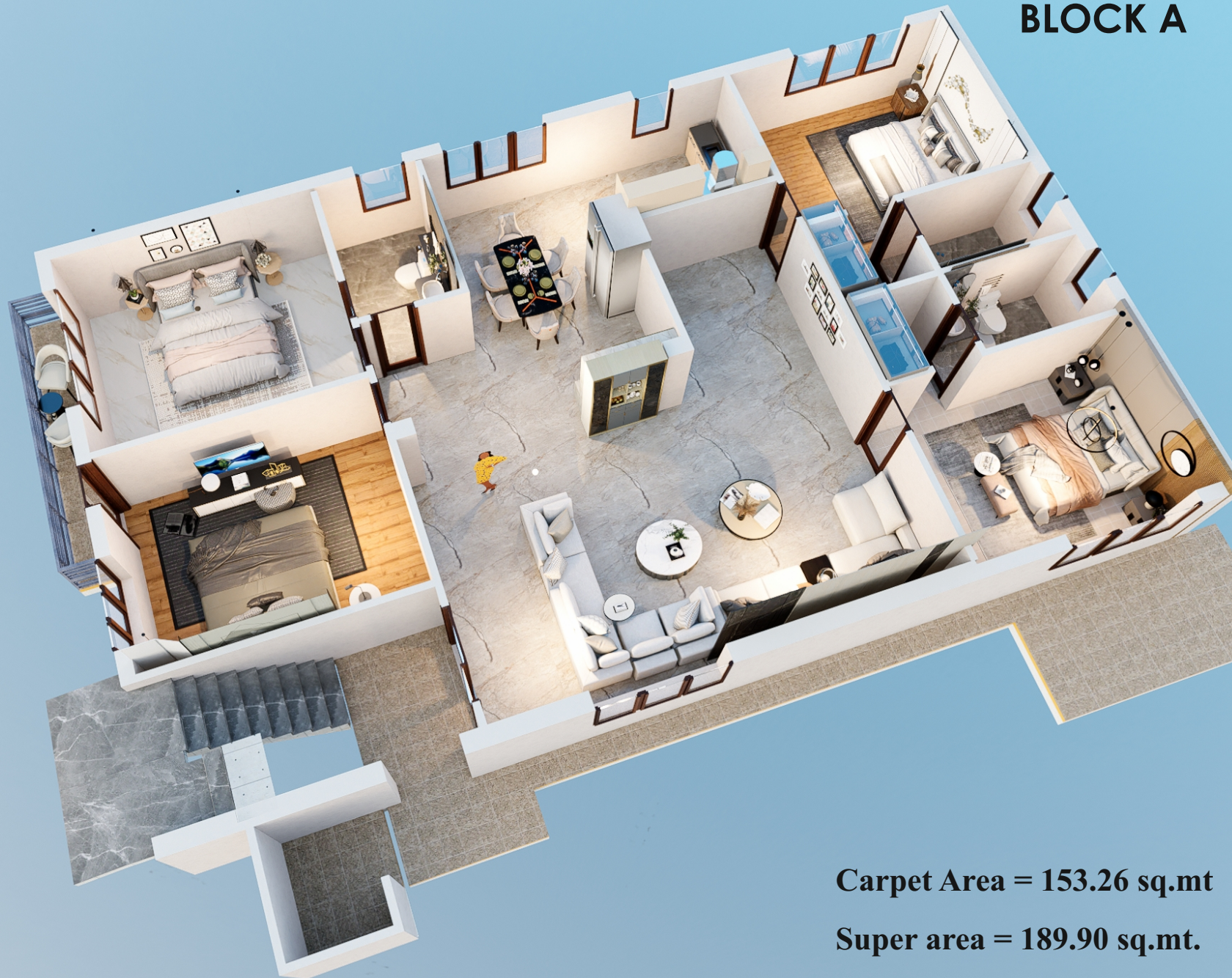

Carpet Area = 153.26 sq.mt

Super area = 189.90 sq.mt.

BLOCK B



Caepet area = 140.95 sq.mt

Super area = 180.30 sq.mt

BLOCK B



Caepet area = 140.95 sq.mt

Super area = 180.30 sq.mt

BLOCK C



Carpet area = 73.46 sq.mt
Super area = 108.10 sq.mt

BLOCK C

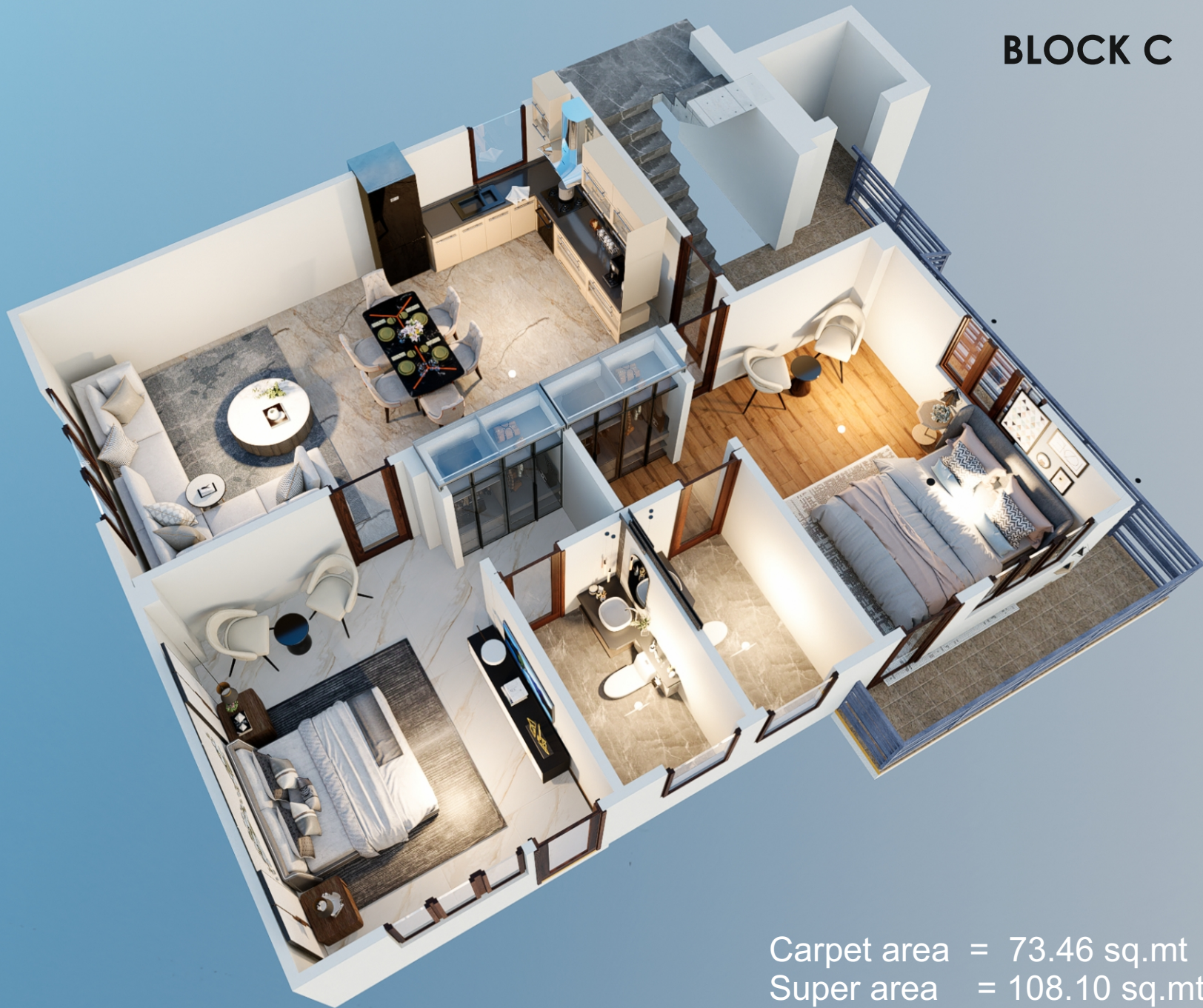

Carpet area = 73.46 sq.mt
Super area = 108.10 sq.mt